

# MANUAL INSTRUCTION



## Safety Notice:

- ❶ Installation should be done by registered electricians.
- ❷ Never touch the working luminaire
- ❸ In any case of malfunction, switch off the power supply immediately, and do not try to repair it yourself.
- ❹ Repairment should only be done by registered electricians or official service agent.

## Include



## Not Include



Model	Power	Fixing Hole Centre
SR05-18W-630 INJECTION ITEM	18W	470mm
SR05-36W-1230 INJECTION ITEM	36W	1020mm
SR05-50W-1530 INJECTION ITEM	50W	1320mm

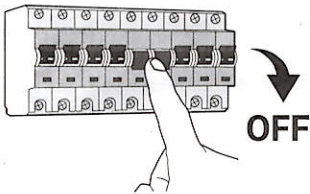

## WARNING

Switch off the power supply before installation

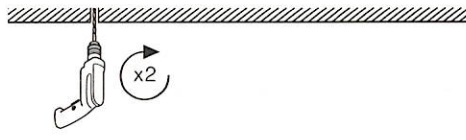

1. Drill a  $\varnothing$  6mm hole

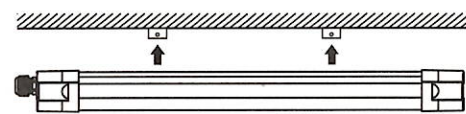

3. Fix the luminaire with the brackets

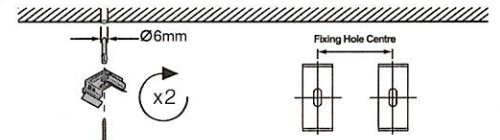

2. According to the Fixing hole centre, instal expansion bolts and screws, instal the bracket.

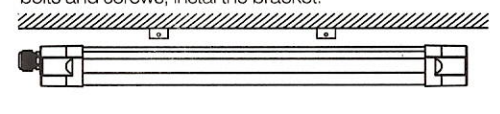

4. Finish installation

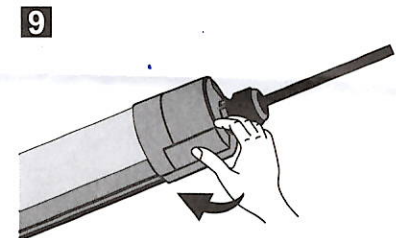
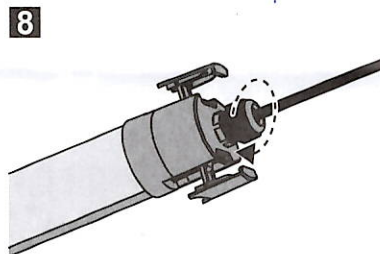
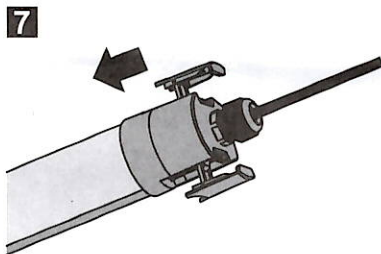
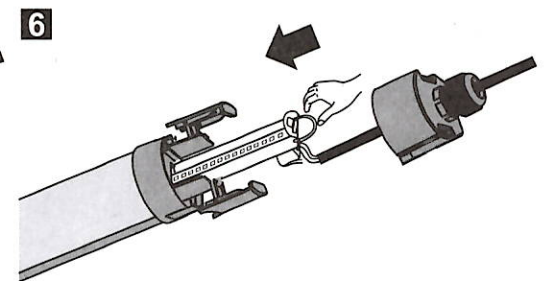
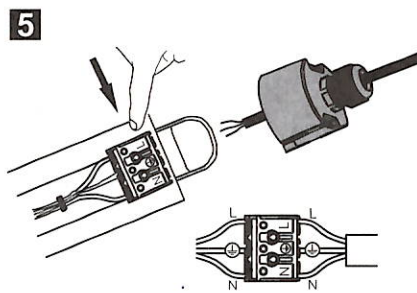
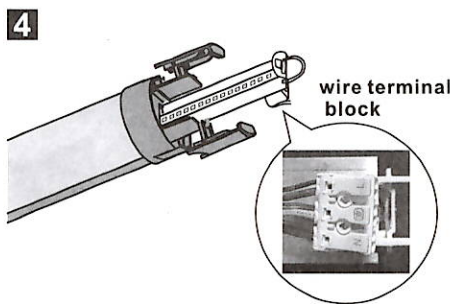
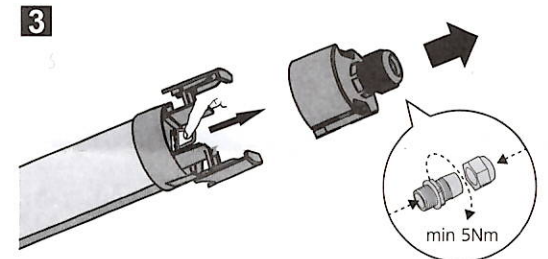
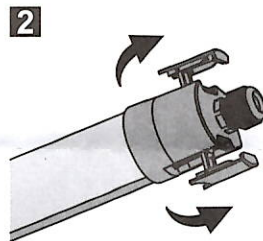
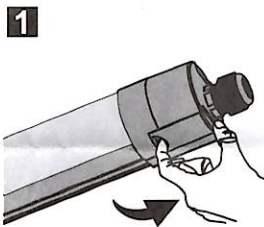

## WARNING

Switch off the power supply before installation

